

These drawings and specifications are the property of H2W Technologies, Inc. They are issued in confidence and shall not be reproduced, copied, or used without written permission from H2W Technologies, Inc. (www.h2wtech.com)

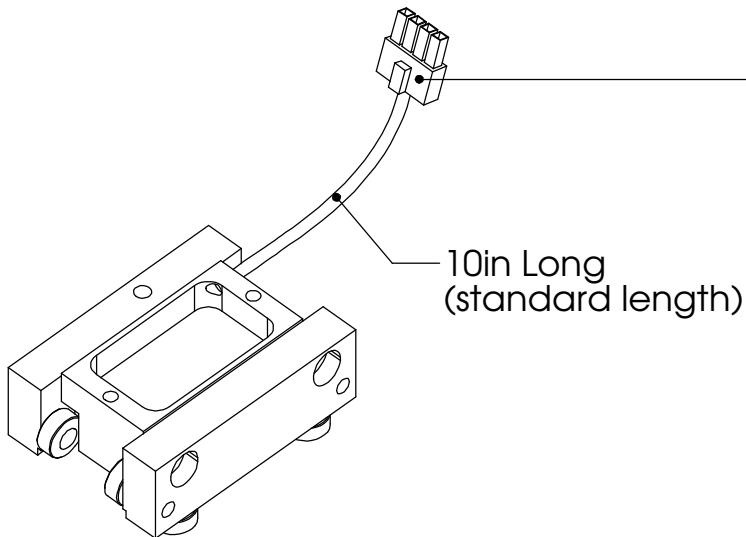
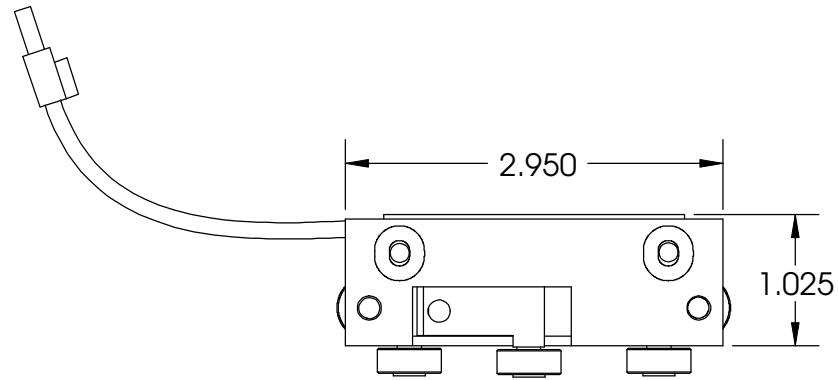
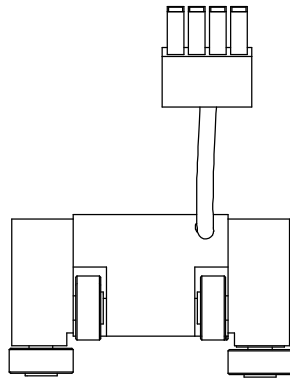
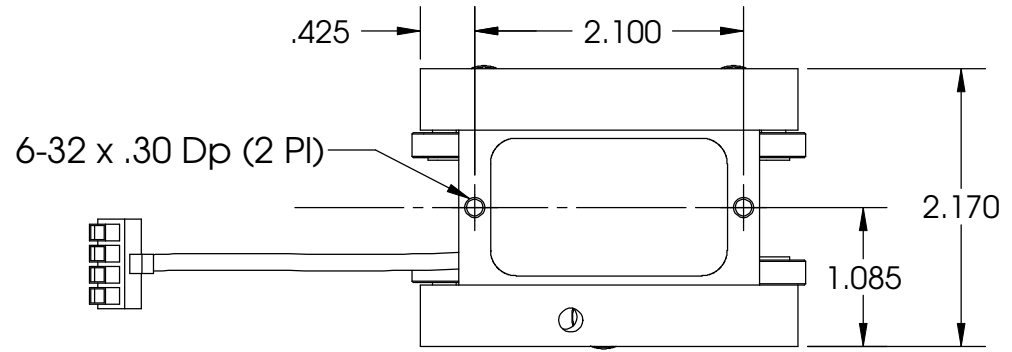

Motor Power Connector
P/N: Molex 39-01-4041

Lead Color	Function
Yellow	A+
White	A-
Red	B+
Black	B-

Mates with Molex P/N: 39-01-4046

Forcer Model # STS-0213-R

H2W Technologies, Inc.

28310-C Ave Crocker Valencia, CA 91355 USA
Tel: (661)-702-9346 Fax: (661)-702-9348
www.h2wtech.com

UNLESS SPECIFIED OTHERWISE:
All dimensions are in inches
Standard Tolerances are as follows:
.XXX ±.005 ANGLES +1°
.XX ±.010 FILLETS .010
X ±.020 CORNERS .010
Remove All Burrs and Sharp Edges

MATERIAL			
FINISH			
DRAWN	DATE	APPROVED	DATE
OOG	8-1-10	MPW	8-1-10

TITLE			
2lb Linear Stepper Motor			
DWG#	REV	SHEET	
10-0463	---	1 of 4	

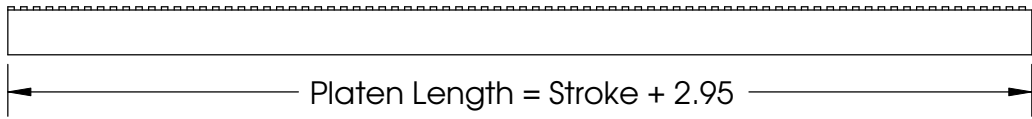
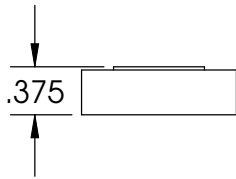
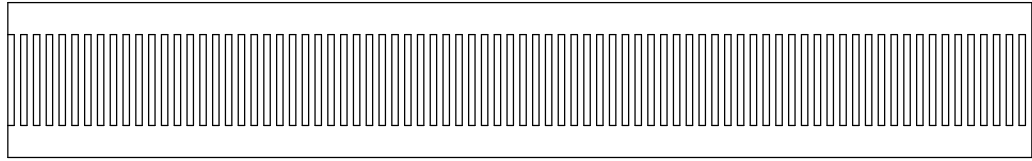

8-32 x .20 Dp

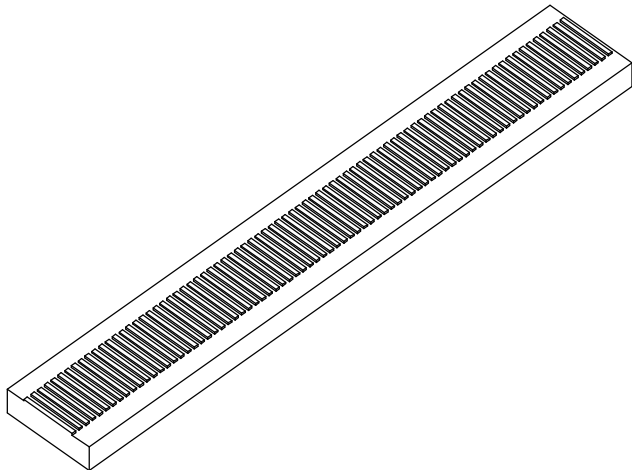
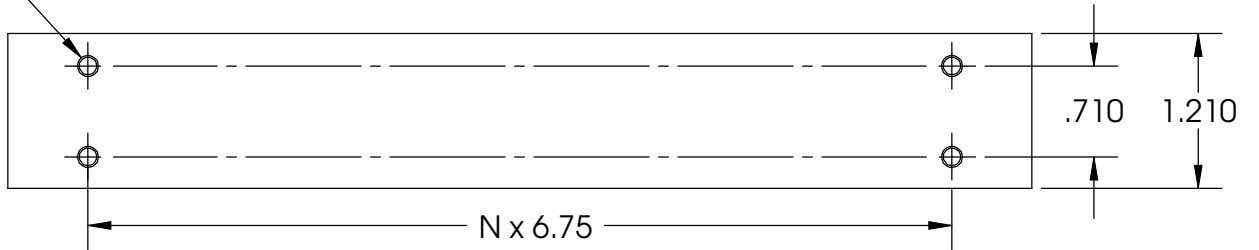

Platen Model # STP-13-XXX-R

TITLE
2lb Linear Stepper Motor

XXX = Platen Length in inches

DWG # **10-0463**

REV ---

SHEET
2 of 4

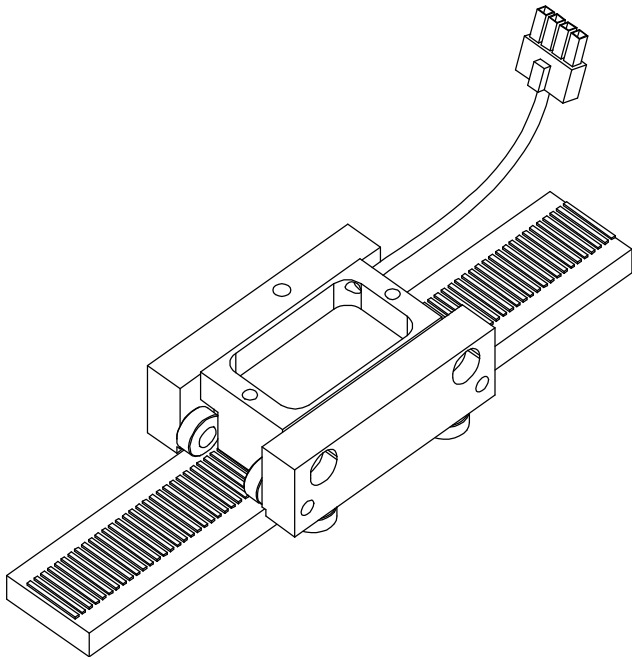
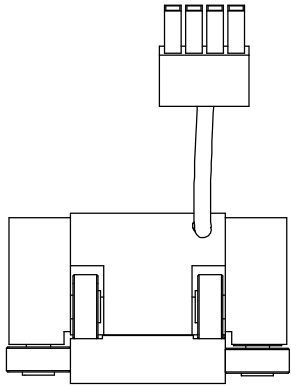
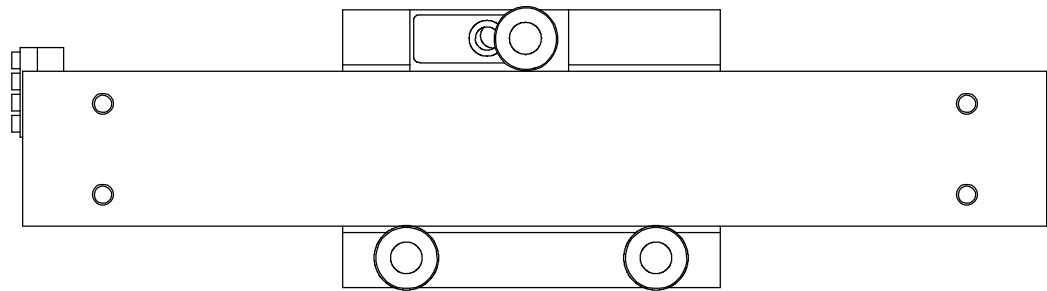
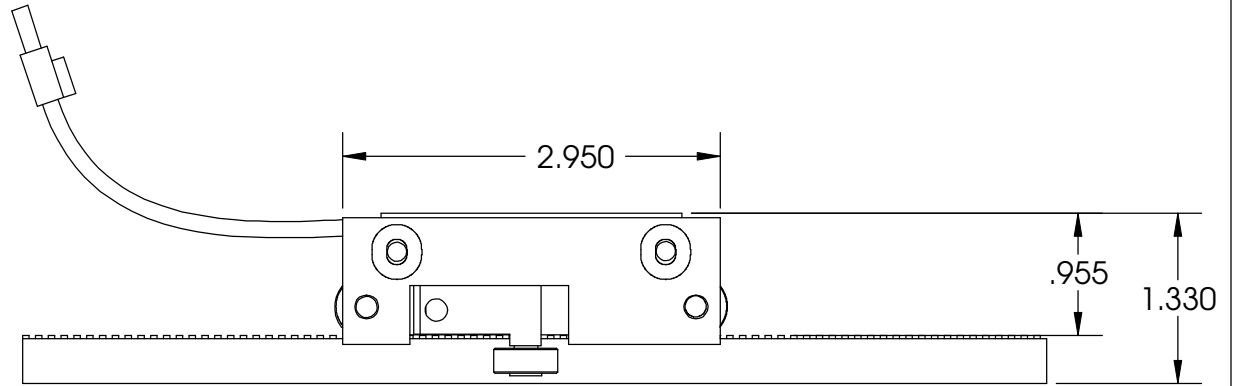
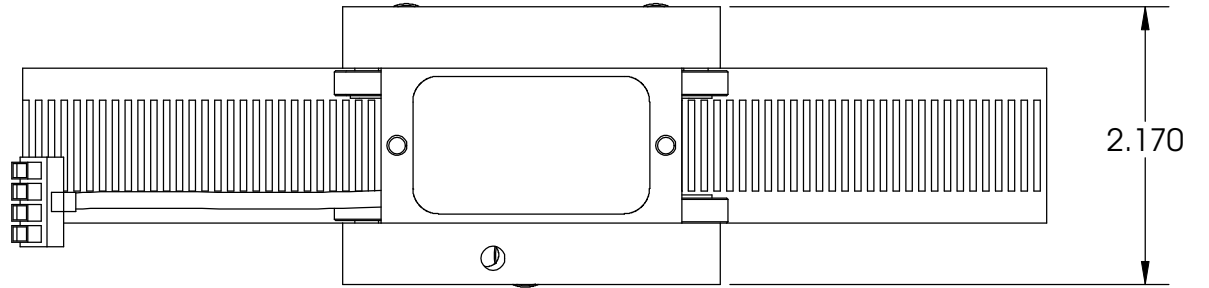

Forcer Mounted on Platen

TITLE	2lb Linear Stepper Motor		
DWG #	10-0463	REV	---
		SHEET	3 of 4

LINEAR STEPPER MOTOR SPECIFICATIONS

Motor P/N	STS-0213-R	
Continuous Force	2.30 LBS	10.22 N
Rated Current	1.0 Amp	
Resistance/Phase @ 20C	0.85 ohms	
Inductance/Phase @ 20C	2.15 mH	
Motor Phases	2	
Bearing Type	Roller Bearing	
Nominal Airgap	0.0015"	
Motor Mass	8.1 oz	230 grams